



# **YOUR GUIDE TO PRE-PLANNING WITH OUR CEMETERIES**

# TABLE OF CONTENTS

|    |  |    |                                |
|----|--|----|--------------------------------|
| 6  | The Benefits of Pre-planning             | 27 | Entombment                     |
| 7  | Why Pre-Plan?                            | 28 | Associated Products & Services |
| 9  | Talking to Loved Ones About Pre-planning | 29 | Interment Rights               |
| 10 | When a Death Occurs                      | 31 | Beechwood Cemetery             |
| 11 | What Should You Do?                      | 33 | Duffin Meadows Cemetery        |
| 12 | Our Pre-planning Advisors                | 37 | Elgin Mills Cemetery           |
| 14 | Your Commemorative Options               | 40 | Meadowvale Cemetery            |
| 15 | Memorial Services                        | 47 | Mount Pleasant Cemetery        |
| 17 | Funeral Centres                          | 52 | Pine Hills Cemetery            |
| 18 | Ground Burial                            | 56 | Prospect Cemetery              |
| 20 | Memorials                                | 61 | Thornton Cemetery              |
| 23 | Cremation                                | 64 | Toronto Necropolis Cemetery    |
| 24 | What is Cremation?                       | 67 | York Cemetery                  |
| 24 | Advantages of Cremation                  | 70 | Map of Locations               |
| 25 | Cremation Witnessing                     |    |                                |
| 26 | Memorialization After Cremation          |    |                                |



**AT MOUNT PLEASANT  
GROUP OF CEMETERIES,  
WE WORK WITH YOU TO  
MAKE SURE THAT YOUR  
FINAL ARRANGEMENTS  
ARE AS MEMORABLE  
AS THE LIFE THEY  
CELEBRATE.** Our purpose is

to provide each and every person with care, compassion and choice, while meeting all their cultural and budgetary needs. The memories of life and the wishes of loved ones are the heart of everything we do.

Mount Pleasant Group of Cemeteries is one of the largest cemetery organizations in the province, owning and operating ten cemeteries in the Greater Toronto Area. We have been providing caring and professional service to the community since our organization was founded in 1826. As a non-profit and non-sectarian organization, we provide caring service to everyone, regardless of his or her affiliation or religious beliefs.

The information in this brochure will give you a good overview of your planning options with us and introduce you to our ten cemeteries.



**Wildlife Outlook**  
*Meadowvale Cemetery*



## **THE BENEFITS OF PRE-PLANNING**

Although planning your final arrangements can be hard to think about, pre-planning gives you the benefit of controlling the details and making sure you are remembered exactly how you want. Our Pre-planning Advisors will help answer all your questions, weigh your options and take you through every step of the process.

# WHY PRE-PLAN?

## **Alleviate the burden on family and friends.**

When somebody passes away without pre-arranging their cemetery and funeral services, their loved ones can be left with tough decisions and a great deal of uncertainty during an already difficult time. By pre-planning, you will make your wishes known, provide direction to the executor of your estate, and avoid any important decisions being influenced by grief or other emotions.

## **Take time to make an informed decision.**

Planning ahead can be very comforting because it gives you the opportunity to make an informed decision about your funeral and cemetery services and the form of memorial you prefer. With time on your side, you can relax and give real thought to the details of your arrangements.

## **Protection from rising costs due to inflation.**

Pre-planning allows you to purchase your services at today's prices, free from inflationary pressures in the future. You will also gain peace of mind knowing that your family and friends will be relieved of the financial burden often associated with making arrangements when a death occurs.

## **Guaranteed Contracts and Cancellation Privileges**

Your payment(s) go into our Pre-Need Trust Fund, and you will receive a contract outlining the terms and conditions of your purchase and your cancellation privileges. All of the terms and conditions will be fully explained to you by one of our helpful professionals.



**Product Selection Room**  
*Meadowvale Funeral Centre*



# TALKING TO LOVED ONES ABOUT PRE-PLANNING

If you are reading this information with a loved one in mind, you might be wondering how to broach the subject of pre-planning their final arrangements. An open conversation can bring tremendous peace of mind on all sides, so here are some scenarios that can help start an honest discussion with your loved one.

## **A loved one asks you to be an executor of his or her will.**

This is one of the most natural opportunities to introduce the subject of his or her final arrangements.

## **Your loved one brings up the topic on his or her own.**

This is not unusual, especially if your loved one has recently experienced the death of someone they care about. The important thing is to listen and encourage their need to talk about their feelings and wishes.

## **Your loved one is seriously ill.**

In this situation, you may feel as though talking about final arrangements is the equivalent of giving up hope. Therefore, approach the discussion in the context of ensuring your loved one's last wishes are fulfilled should death occur.

## **The subject comes up naturally.**

If you are visiting a cemetery, for example, this can be the appropriate occasion to ask your loved one about his or her wishes.

## **Discuss your own arrangements.**

This will make the conversation more of a sharing experience and will help your loved one feel more at ease.

## **Everyone benefits from pre-planning.**

There are many decisions to be made, and an honest discussion is the first step in making final arrangements that truly celebrate your loved one's life the way he/she would have wanted.

# **WHEN A DEATH OCCURS**

When a death occurs, having an idea of what to expect will help you stay calm and keep from getting overwhelmed. The following will provide a guideline of what you will have to consider when a death occurs.

If you are at home when an unexpected death occurs, the first thing you should do is dial 911. Emergency Services will be dispatched. You may contact a funeral home to make arrangements to transfer your loved one. If it is decided that an autopsy is required, the deceased will be taken to the coroner's facility before they can be transferred to the funeral home. The timing of the release of the body from the coroner to funeral home will be discussed with you.

If the death occurs at a hospital or nursing home, you can contact a funeral home to arrange to transfer your loved one.

# WHAT SHOULD YOU DO?

## Notification

The deceased's relatives, friends and employer should be notified. If the deceased was an active member of a religious community, his or her spiritual leader should also be alerted. The clergy can be a source of great comfort during this difficult period.

## Cemetery Arrangements

If cemetery arrangements have been pre-planned, contact the cemetery right away, then advise your funeral home. They will need to know the name of the cemetery where the arrangement was made, what type of service you want, and the location of interment rights, found on the Interment Rights Certificate.

If cemetery arrangements have not been made, the next steps will be to choose a cemetery, decide how much you want to spend, select ground burial, entombment or cremation, and determine the details of the memorial.

## Funeral Arrangements

If the funeral has been pre-planned, contact the funeral home handling the arrangements. If you have not already chosen a funeral home, contact your preferred cemetery to learn about the funeral home options in your area. If you have not selected a cemetery, the knowledgeable professionals at any of our ten cemeteries would be happy to assist you.

## The Information Needed to Make Arrangements

In order to make cemetery arrangements, you will need the deceased's full name, full address, date and place of death, date and place of birth and full name of the next of kin. Your funeral provider will also need the deceased's Social Insurance Number for the Statement of Death.

## Financial Considerations

You don't want to be thinking about money during such an emotional time, but some things must be taken care of, such as interment rights and cemetery service fees. If financial assistance is required, we can inform you of some organizations that can help.

## OUR PRE-PLANNING ADVISORS

Our multilingual, multicultural Pre-planning Advisors are here to make things easy for you and will work with you to plan your final arrangements exactly the way you want them. Knowledgeable, honest and open, they can answer all your questions and take you through every step of the pre-planning process according to your own comfort level.

You can make an appointment with a Pre-planning Advisor by contacting the cemetery office near you or by visiting the Pre-planning Advisors section of our website at **mountpleasantgroup.com**. We would be happy to meet with you in our offices, or if you are unable to come to us, one of our Pre-planning Advisors will come to you.



Arrangement Room

# **YOUR COMMEMORATIVE OPTIONS**

The number of ways to make your final arrangements is as limitless as your imagination. Your personal needs and preferences are always taken into account, whether they are religious, traditional or financial. Across our ten cemeteries, we have a full range of burial options, facilities and products to accommodate your commemorative needs. Even if you are not sure what form of commemoration you prefer, we will be happy to assist you. From cremation to entombment, from memorial services to traditional markers, the decisions are all yours and we will work with you every step of the way to make your choices as easy as possible. The following sections outline the many options available to you.

# MEMORIAL SERVICES

Memorial services help us give testimony to the life of the deceased, and are a meaningful way to express our feelings about the loss of a loved one. Memorial services can be held in a place of worship, at one of our funeral centres, at a funeral home, or at another location that holds special meaning for you and your family. With Mount Pleasant Group of Cemeteries, you have the opportunity to work with an advisor who will help to create a service that truly reflects a life lived, no matter how simple or elaborate.





# FUNERAL CENTRES

When our first funeral centre was opened at Pine Hills Cemetery in 1999, it was the first time in Toronto that a single facility could hold a visitation, a funeral, cremation or memorial service, an interment or burial, and a reception all in one beautiful setting. Since then, Mount Pleasant Group of Cemeteries has opened funeral centres at York Cemetery, Elgin Mills Cemetery, Meadowvale Cemetery, Mount Pleasant Cemetery and Thornton Cemetery, each with their own unique features.

## **At Your Convenience**

Our modern state-of-the-art facilities provide a bright and spacious atmosphere where family and friends can gather to remember their loved one. All of our funeral centres can be individually customized around your final wishes—however traditional or contemporary. Our helpful professionals are available at any time to give you a tour of the facilities and help you create a beautiful and meaningful tribute.

# GROUND BURIAL

Interment, more commonly known as ground burial, is still the most common of all cemetery services. There are a variety of options available to you when you choose ground burial. In most cases a single grave or lot can accommodate either two casket burials or cremations. Interment rights are available in various sizes of graves which can allow for flat memorials or lots which accommodate upright monuments.



# MEMORIALS

When you choose ground burial, we can help you create a memorial that celebrates a life and serves as a record for future generations. The most common memorials are upright granite monuments or flat markers of bronze or granite set flush with the ground. The options available are vast and the possibilities for personal expression are endless. Additional products such as vases and photoceramics are also available to complement the memorial.

No matter what approach you want to take, our advisors and artisans will help create a memorial tribute of enduring beauty that best reflects the person being remembered.





Granite-Fronted Cremation Niches

# CREMATION

Mount Pleasant Group of Cemeteries established Ontario's first crematorium in 1933 and we have a continuing tradition of providing options to those who choose cremation. All of our cemeteries provide innovative options in beautiful settings dedicated to the memorialization of cremated remains. Cremation is becoming an increasingly popular option, and if you are considering it, the following sections will help answer your questions and give you an idea of all the unique cremation memorials that are available to you.

## **WHAT IS CREMATION?**

Cremation is simply one method of preparing a loved one for memorialization. In a cremation, the casket is placed in a chamber where the temperature is raised to extremely high temperatures. After approximately 90 minutes, all organic matter is consumed, leaving behind bone fragments, known as cremated remains or more commonly as ashes. The ashes are then processed into finer particles and placed in a temporary container or an urn provided by the family.

Ashes can be buried in a cremation grave or lot, placed in a niche above ground, buried in a family grave or lot where space and cemetery by-laws permit or, if you are not ready to make a decision regarding a final resting place at this time, the ashes can be taken home. Some individuals request to have their loved one's ashes scattered in a meaningful place. Our advisors will take the time to help you understand all your options.

## **ADVANTAGES OF CREMATION**

Cremation is popular for many different reasons, including environmental concerns, religious reasons, and simplicity. One benefit to cremation is the increased flexibility it provides you, with respect to the timing of your funeral and cemetery arrangements. You might, for example, choose to have a funeral service before the cremation; a memorial service at the time of cremation or after the cremation with the urn present; or a committal service at the final disposition of the cremated remains. Additionally, we have become a much more mobile society and often families are spread distances apart. Cremation allows the ashes to be split among family members in keepsake urns and jewellery so their loved one can be with them, wherever they live.





## CREMATION WITNESSING

Cremation witnessing is another way to say a final goodbye to a loved one prior to the cremation. It feels a lot like a memorial service or graveside service.

At our cremation centres, family and friends can gather in the bright, well-lit, modern and comfortable witnessing rooms. There, the casket is placed on a special lift in front of the cremator doors. If the family wishes, they can ask a faith leader, celebrant or officiant to share a few comforting words with the group and then, at the appropriate time, a button is pressed by a designated family member or one of our staff, automatically opening the doors and gently pushing the casket directly into the cremation enclosure, where the cremation process begins.

The benefits of witnessing are largely personal. For some people, being present when the casket takes its final journey into the cremation enclosure is comforting or may be part of their traditions. For others, it may demystify something that they weren't able to be part of in the past. But until recently, North American crematoriums weren't suited to accommodate witnessing. Most are old, cramped and very hot. We have upgraded all of our crematoriums with state-of-the-art equipment and entirely new, welcoming environments that completely transform the experience. Now families and friends can witness cremation in a dignified space in comfort.

# MEMORIALIZATION AFTER CREMATION

## The Urn of Your Choice

We offer a variety of urns covering a wide range of styles, sizes and prices. Some commonly chosen options include urns made from wood, bronze, marble, ceramic, or glass. Our advisors will be happy to show you a vast array of available choices.

## Cremation Graves

Cremation graves and lots are available for those who have chosen cremation, and prefer the elegance of traditional ground burial. Cremation graves will accommodate up to two urns. Memorial options available include a marker set flush with the ground, or an upright monument.

## Urn Entombment

A niche is a recessed compartment designed for the permanent placement of urns. Single niches for one cremation urn, double niches for two urns side-by-side, and family niches for up to four are all available.

An arrangement of niches is called a columbarium and some columbariums are located in a gathering hall or mausoleum, while others are located outdoors, in picturesque settings. Following an urn entombment, a niche front of granite, marble, bronze, wood or glass is attached. For a more personal memorial, glass-fronted niches allow small tokens or pictures to be placed alongside the displayed urns and remain visible. Not all types of niches are available in all columbariums, so please check with the cemetery office for availability.

# ENTOMBMENT

Many people think that mausoleum entombment is only for the wealthy who have a private family mausoleum. The truth is that community mausolea—like the ones at Mount Pleasant Group of Cemeteries—make mausoleum entombment a convenient option available to everyone.

## What is Entombment?

Entombment is the interment of human remains in a tomb or crypt, and is sometimes referred to as above-ground burial. It involves placing a casket in an individual compartment, or crypt, within a mausoleum. The crypt is then sealed and a granite or marble front is attached.

There are a number of meaningful ways to celebrate a life through memorials when entombment is chosen. The crypt front allows for personal inscriptions, as well as the placement of other personal touches and meaningful items, including photographs, emblems and memorial lights.

## What is a Mausoleum?

A mausoleum is a building that provides above-ground burial space or entombment for a number of different people. It may be a private family mausoleum, or a community one shared by unrelated people. Mount Pleasant Group of Cemeteries currently operates several unique mausolea across different cemeteries.

## What are Crypts?

Crypts are individual compartments designed to hold casketed remains. Single crypts are designed for one entombment. We also offer two types of double crypts—tandem crypts which permit two entombments lengthwise, and companion crypts for two entombments side-by-side or one above the other. Our community mausolea are typically built five crypts high on each floor. Indoor crypts have marble fronts, and outdoor crypts have granite fronts. Most of our mausolea offer a wide selection of crypts, priced to meet all wishes.

# ASSOCIATED PRODUCTS & SERVICES

Whether you live far away, or can't visit the grave often enough, or simply want to know that the grave is always well-kept and tidy, we offer special services for tending to a grave. From maintenance to the placing of wreaths to planting, here's what we offer:

## Special Care Program

As an option for those desiring that extra touch, our seasonal Special Care Program provides individualized attention to your grave or lot beyond the general care and maintenance provided to the overall cemetery. You can ensure the neat appearance of the grass and the care of flowerbeds at an additional annual cost. This service is offered from June 1st to August 31st each year.

## Flowerbed Program

This service is for those who find comfort in the beauty of flowers and a simple touch of colour is all that's needed to a grave or lot. For an additional cost, we will plant vibrant begonias at the grave for you to enjoy gorgeous blooms all season. You can contact the cemetery directly for costs and details. This service is offered from June 1st to August 31st each year.

## Wreaths

Wreaths are a meaningful way to pay tribute to the deceased. We offer a variety of memorial wreaths and monument saddles throughout the year. While memorial wreaths can only be placed from November through March, monument saddles which are designed to be mounted on top of upright monuments, are permitted all year long. All wreaths purchased from Mount Pleasant Group of Cemeteries include a complimentary wreath stand and set-up service.

In addition to the products and services already detailed, we also offer the following items to create special remembrances and give that added, personal touch to any service.

## **Vaults**

Casket and urn vaults provide an added layer of protection against exterior elements for the casket or urn. There is a wide range of vaults, with various degrees of reinforcement and design features.

## **Keepsakes**

There are a variety of keepsake options that can help you feel continually connected to a departed loved one, and preserve their memory in a more physical way. You may wish to store a small amount of cremated remains or a lock of hair within a piece of keepsake jewellery, a small keepsake urn, or even a plush teddy bear. We can help you find just the right keepsake to memorialize and keep a loved one close to heart.

# **INTERMENT RIGHTS**

Your cemetery options are many and varied, but no matter what decisions you make, you need to purchase interment rights. Purchasing interment rights is what allows you to specify who may be buried or entombed in the space, rather than purchasing the grave/lot/cremation, grave/crypt or niche itself, which remains the property of the cemetery. Interment rights include the right to place a memorial where permitted.

## **Care and Maintenance**

As prescribed by Ontario legislation, a portion of the price of interment rights is contributed to the Care and Maintenance Fund. The income generated by the Fund is used to ensure the regular care and maintenance of the cemetery grounds is maintained in perpetuity.



Cemetery Office



Mausoleum of the Madonna

# BEECHWOOD CEMETERY

Beechwood Cemetery, renowned for its tranquil setting and breathtaking mausolea, has been serving the City of Vaughan and the neighbouring community of Downsview since 1965.

## Surrounded by Beauty

Beechwood offers 99 acres of gently rolling landscape containing a number of mature trees and large, colourful flowerbeds.

## Your Options

There are a variety of burial options available to suit your personal wishes, including graves with flat markers and upright monuments. Beechwood also features four beautiful mausolea providing the option for entombment. Another stunning feature of the cemetery is the veterans' section, highlighted by a granite veteran memorial.

If you choose cremation, there are several peaceful areas for urn burial, including a stone feature with surrounding markers, as well as cremation lots adjacent to boulders and lovely limestone walls. Both indoor and outdoor niches are available, namely glass-fronted niches in the Mausoleum of the Madonna and granite-fronted niches in an elegant, domed outdoor columbarium. Cremated remains can also be interred in a grave, family lot, or cremation lot.

### *Mausoleum of the Madonna*

In 2009, Beechwood Cemetery responded to the continuing needs of the community by opening the Mausoleum of the Madonna. With over 43,000 square feet of space, this impressive two-storey Italian-inspired building provides an array of entombment options, including single, companion, vertical companion and couch crypts. A selection of bronze or stainless steel vases, lamps and photo frames is also available.

The mausoleum features private family rooms separated from the main corridors by locking glass gates. A large skylight and magnificent statuary, including a 10-foot tall Welcoming Madonna in a recessed alcove, highlight the central gathering hall. The Mausoleum of the Madonna also features an espresso lounge, atrium, elevator access to the second floor and secured keypad access.



Cemetery Office



Garden of Remembrance



# DUFFIN MEADOWS CEMETERY

Duffin Meadows is the newest of the Mount Pleasant Group of Cemeteries, but its heritage and historic location underscore much of Durham's rich pioneer past. Serving Ajax, Pickering and Scarborough since 1993, and conveniently located just 15 minutes east of Toronto, the site boasts natural valleys, ponds, rolling meadows and mature trees that will form the basis of many attractive features as the cemetery develops over the coming years.

## **A Picturesque Environment Now and Forever**

Duffin Meadows was originally a farm, dating back to the late 1800s, and the traditional rural character of the area influences the development of these grounds. The original farmhouse has even been renovated and serves as the cemetery office. To date, only a portion of Duffin Meadows' 80-acre site has been developed, but future expansion will see this unique property's country flavour faithfully incorporated into innovative burial, cremation and memorialization options.

## **Your Options**

There is a wide selection of ground burial options, including single graves and larger lots, both of which can be marked with a flat memorial or upright monument. A range of cremation lots and niches is available for those who choose cremation, including granite-fronted niches in columbaria surrounded by lovely rose gardens and beautiful landscaping. A stunning cemetery within a cemetery, the Garden of Remembrance at Duffin Meadows also offers a variety of interment options in exquisite settings for those choosing cremation.

## ***Serving the Community***

Mount Pleasant Group of Cemeteries has a tradition of creating unique feature areas to serve the needs of all cultures and faiths. In 2002, Duffin Meadows added a section designed specifically to meet the needs of the Chinese community. Duffin Meadows also has a veterans' section providing a lovely setting for the burial of Canadian and Allied veterans and their spouses.



### *Natural Burial Section*

Located between Sections 15 and 16 at Duffin Meadows, it is the second Natural Burial Section offered by Mount Pleasant Group of Cemeteries, the first such section is offered at our Meadowvale Cemetery location in Brampton. Designed to let nature take its course, promote a “tread-free” mind-set and encourage people to refrain from walking on the graves, the plants and grasses in these burial grounds are left to grow freely.





Cemetery Office



Granite Upright  
Monuments

# ELGIN MILLS CEMETERY

Elgin Mills Cemetery has been providing service to the town of Richmond Hill and the communities of Markham, Aurora and Thornhill since 1979. This stunning cemetery features a full range of interment choices, a veterans' section, a cremation centre, and a beautiful funeral centre.

## **Picturesque Setting**

Elgin Mills boasts a large, natural setting in a convenient location just north of Toronto off Highway 404. The headwaters of the Rouge River run through the east end of this vibrant cemetery, adding to the tranquility of the grounds. The numerous trees planted throughout Elgin Mills include the “nuttery,” a collection of nut-bearing trees that blossom in the spring. The cemetery's large flowerbeds are planted seasonally, which add to the natural splendour of the environment.

## **Your Options**

Elgin Mills has a wide variety of burial options, including flat marker graves, lots permitting upright monuments and a veterans' section. For those who choose cremation, Elgin Mills offers beautiful special feature areas for urn burial, cremation burial plot adjacent to a granite wall, a landscaped columbarium with granite-fronted niches, and an indoor columbarium with glass-fronted niches.

For entombment, Elgin Mills has the indoor Mausoleum of the Heavens, featuring white marble crypt fronts. The mausoleum also features an extraordinary stained-glass window, a hand-painted sky relief on the ceiling, heating, air conditioning, and a choice of several bronze vases, lamps and photo frames.

## ***Funeral Centre***

The convenient funeral centre at Elgin Mills gives you the option of housing the visitation, funeral, cremation, interment or memorial service, as well as the reception all in one stunning location. Our bright and open funeral centre features two visitation rooms, and two peaceful reception rooms each with a fireplace and access to an attractive outdoor patio. The stunning gathering hall seats 200 people and is notable for its magnificent wooden arches and three-storey high glass wall.



**Cremation Centre**

### ***Cremation Centre***

Outfitted with a modernized, advanced cremator technology system in 2014, the cremation centre at Elgin Mills was designed with witnessing in mind and can host up to 100 guests. An extension of the funeral centre, families can now have a chapel service, cremation and reception after an interment service all in one location and with the new cremation technology all of this can be completed in one day.

### ***Funeral Centre***

The convenient funeral centre at Elgin Mills gives you the option of housing the visitation, funeral, cremation, interment or memorial service, as well as the reception all in one stunning location. Our bright and open funeral centre features two visitation rooms, and two peaceful reception rooms each with a fireplace and access to an attractive outdoor patio. The stunning gathering hall seats 200 people and is notable for its magnificent wooden arches and three-storey high glass wall.



Gathering Hall

# MEADOWVALE CEMETERY

Meadowvale Cemetery is a beautiful 127-acre property, notable for its two-acre wildlife sanctuary, award-winning landscape architecture and its stunning Garden of Remembrance. Meadowvale has been providing caring service to the cities of Brampton, Mississauga and neighbouring communities since 1981.

## Your Options

Meadowvale offers a full range of services with a wide variety of burial options. For those who choose cremation, you have the option of cremation lots or niches in the Garden of Remembrance or scattering the ashes in our cremation ossuary.









**Natural Burial Section**

### ***Natural Burial Section***

Meadowvale Cemetery also features a natural burial section adjacent to a wildlife preservation area, offering families a way to return loved ones back to the earth as naturally as possible. To promote the natural burial process, embalming is not permitted, biodegradable caskets, shrouds or urns must be used, and burial vaults are not allowed.

### ***Veterans' Section***

The veterans' section at Meadowvale houses a stunning central sculpture entitled Conflict. Also in this section is the Korea Veterans Wall of Remembrance—a National Memorial with bronze plaques commemorating 516 Canadians who gave their lives in the Korean War.



**Eternal Gardens**

### *The Garden of Remembrance*

Our Garden of Remembrance offers a special place of contemplation for people who choose cremation. This breathtaking garden blends innovative options with inspiring natural surroundings. The Garden consists of three unique theme areas where ashes can be buried or placed in a niche.

A central fountain feature marks the Eternal Gardens, an area surrounded by low architectural walls and floral gardens. Urns can be placed within the walls or adjacent to them. Groups of niches that accommodate urns are also found here, and feature colourful combinations of granite fronts. The treed area that surrounds the Eternal Gardens is aptly named the Memorial Lawns, and features cremation lots permitting upright granite monuments. Secluded niches with bronze and granite fronts overlook the large and peaceful Pond of Reflection.

### *Funeral Centre*

Our newly added funeral centre combines the visitation, funeral, cremation, interment or memorial service, and reception all in one beautiful place. Natural light shines down through the pointed rooftop windows of the two-storey Meadow Hall, offering guests a sense of warmth and peace. Visitation and reception rooms offer a quiet escape for loved ones, and the outdoor patio allows for a breath of fresh air.

### *Cremation Centre*

Established in 1981, Meadowvale Cremation Centre includes a stunning chapel with two large windows overlooking the cemetery, and a beautiful stained-glass window by Canadian artist Mimi Gellman. The presence of the chapel means you have the convenience of holding a service and having the cremation take place in one location.

The cremation centre at Meadowvale is the last of our facilities to be upgraded with the most technologically advanced cremation equipment — complete with an emissions abatement system that eliminates nearly 100% of all emissions and particulate matter. Completing the upgrades, the cremation centre was renovated to accommodate expanded witnessing capacity in a comfortable and dignified environment.



Meadow Hall



Cremation Centre



# MOUNT PLEASANT CEMETERY

One of Canada's most historic cemeteries, Mount Pleasant has served the Toronto community since 1876. It is the final resting place of many prominent Canadians, as varied as former prime minister William Lyon Mackenzie King, Jennie Smillie-Robinson, Canada's first female surgeon, popular Métis artist Cecil Youngfox, and pianist Glenn Gould. Mount Pleasant Cemetery is also home to the stunning and spacious Garden of Remembrance, a beautiful funeral centre and the first cremation centre in North America to use advanced cremation technology.

## Art and Nature

Mount Pleasant Cemetery is an open green space with an abundant tree collection that has grown into one of North America's finest arboreta and Canada's only accredited level 2 arboretum through ArbNet. Large flower gardens, birds and other



Cemetery Office

wildlife, contribute to the park-like setting. The cemetery's great natural beauty is enhanced by an array of unique works of art, sculptures and memorials found throughout the grounds.

## **Your Options**

Although Mount Pleasant is a historic cemetery, new and desirable ground burial spaces of various sizes and in various locations are still available. Our office would be glad to inform you of the current selection.

Mount Pleasant Mausoleum is a classic example of Georgian architecture featuring marble-fronted crypts. There are two gathering halls located in the mausoleum for services or personal reflection. For those who choose cremation, cremated remains can be placed in niches inside Mount Pleasant Mausoleum, in outdoor niches in the spacious Garden of Remembrance, or scattered in one of the lovely memorial scattering areas.

### *The Garden of Remembrance*

The Garden of Remembrance offers those who choose cremation a final resting place of great beauty. This cemetery within a cemetery is composed of six theme areas, each with distinct memorialization options that reflect its distinctive physical features.

The Gateway of Hope leads you into the garden between granite-faced columbaria. The Eternal Gardens form a central walkway to the fountain, surrounded by flowers and rose gardens. The Pool of Reflection is the expansive centerpiece of the Garden, which leads to a tranquil stream named the River of Memories. Finally, a pathway winds its way through the Forest of Remembrance, where ashes may be buried among the stand of mature trees. The Garden of Remembrance also includes the Conservatory, a glass-roofed structure, offering numerous granite-fronted niches in a serene and uplifting environment.





Garden of Remembrance

### *Funeral Centre*

Mount Pleasant Funeral Centre gives you the convenience of hosting the visitation, funeral, cremation, interment or memorial service, and reception all in one beautiful state-of-the-art facility. It features a lovely two-and-a-half storey gathering atrium to hold services, elegantly designed visitation rooms and reception areas with direct access to outdoor patios, and a quaint coffee lounge.

### *Cremation Centre*

In 1972, we opened our third crematorium in the Toronto market at Mount Pleasant Cemetery, in the lower level of the Mount Pleasant Mausoleum. Since then, we have continued to serve the growing number of people who choose cremation. As of 2014 Mount Pleasant became the first of our locations, and the first in North America, to be upgraded with the most technologically advanced cremation equipment — complete with an emissions abatement system that eliminates nearly 100% of all emissions and particulate matter. Completing the upgrades, the cremation centre was renovated to accommodate expanded witnessing capacity in a comfortable and dignified environment.



**Cremation Centre**



Funeral Centre  
Gathering Atrium

# **PINE HILLS CEMETERY**

Providing service to the Scarborough and southeast Toronto areas since 1928, Pine Hills Cemetery features lush trees and a beautiful natural setting that offers a peaceful final resting place.

## **A Natural Environment**

Since its inception, more than 17,500 beautiful trees and shrubs, such as white ash, maple, black cherry and elm, have been planted in Pine Hills Cemetery. Massey Creek meanders through the property, colourful flowerbeds decorate the serene setting, and birds and other wildlife can be seen in their natural habitat.

## **Your Options**

A full range of burial options is available at Pine Hills, with everything from single graves to large family lots. For those who choose cremation, there are cremation lots available in several desirable feature areas. Ashes can also be scattered in one of the memorial scattering areas, along the nature walk or cremation ossuary. For those who choose entombment, the Mausoleum of the Risen Christ at Pine Hills blends modern architectural features with old- world craftsmanship into a state-of-the-art facility, complete with Italian white marble crypt fronts and an extraordinary statue of the Risen Christ.

Pine Hills is also home to a lovely veterans' section, the largest in Canada dedicated to Canadian and Allied veterans and their spouses. Over 6,000 veterans are buried in Pine Hills, and it is the site of an annual veterans' pilgrimage each September.



Celtic Cross and  
Cremation Burial Lots



Gathering Hall

### *Funeral Centre*

The funeral centre at Pine Hills was the first such facility established in Toronto, and is unique to the Scarborough area. It allows you to hold a visitation, funeral, cremation, interment or memorial service, and reception all in one comfortable location. The spacious reception rooms are equipped with all the amenities you require, and can accommodate 75 to 100 people. The spacious gathering hall is characterized by high ceilings, warm wood and stone décor, and two large video screens providing optimal view of the service. A full glass wall opening to an outdoor landscaped courtyard allows daylight to fill the room, creating a comforting atmosphere.



Family Lounge Area



Visitation Room

# PROSPECT CEMETERY

Known as “The Cemetery on St. Clair,” Prospect Cemetery has been providing caring service to the western portion of the City of Toronto since 1890. It is home to exquisite works by Canadian artists, and special memorial features include the uniquely beautiful Lights of the Madonna.

## Art and Atmosphere

Over the years, the property’s wonderful natural features have been incorporated into the landscaping, making Prospect a peaceful green space. It also features distinctive pieces of art, including the veterans’ section’s cruciform “Cross of Sacrifice” by architect Sir Edwin Lutyens, and the court mausoleum’s stained glass art by Canadian artist Mimi Gellman.

## Your Options

Prospect Cemetery includes several mausolea and offers a full range of services. If ground burial is your preference, please check with our office about current availability. For those who choose cremation, Prospect offers a range of possibilities such as cremation graves, lovely glass-fronted niches in the St. Clair Mausoleum, marble-fronted niches in the Hall of Niches, and granite-fronted niches in the Mausoleum of the Last Supper. Prospect also offers the unique Lights of the Madonna, a granite feature located at the entrance to Prospect Court Mausoleum. It features an elegant statue of Madonna and Child, and decorative illuminated lights with an inscription engraved on the plaque below. Photoceramic portraits are also an option with the Lights of the Madonna memorial.





Scattering Memorials

### *Mausoleum of the Last Supper*

Just inside the St. Clair entrance of Prospect Cemetery, on the left, is the Mausoleum of the Last Supper. Originally an outdoor structure called Prospect Court Mausoleum, most of the original structure has been entirely enclosed and converted into an indoor, climate controlled mausoleum with close to 1,200 additional crypts. Renamed the Mausoleum of the Last Supper, new white marble-fronted crypts and glass-fronted niches have been added, blending beautifully with the original red granite-fronted crypts. Carpeted throughout, the entire mausoleum is warm and welcoming with lots of natural lighting throughout.

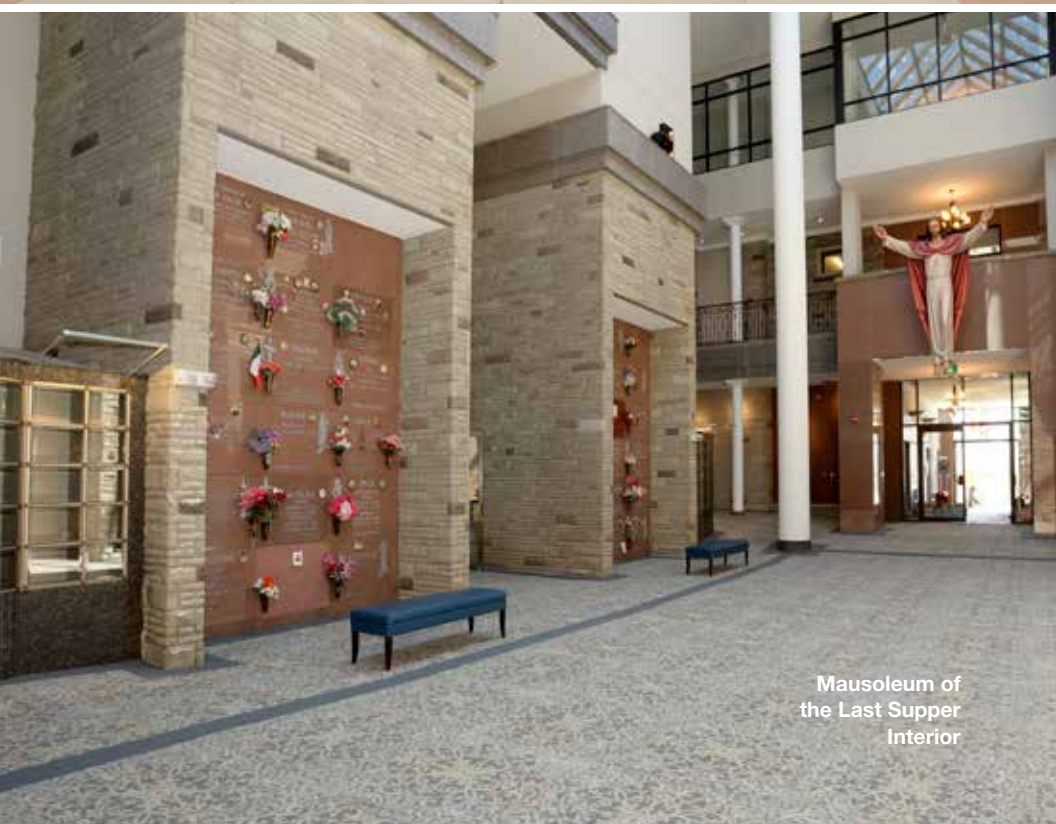

Mausoleum of  
the Last Supper  
Interior

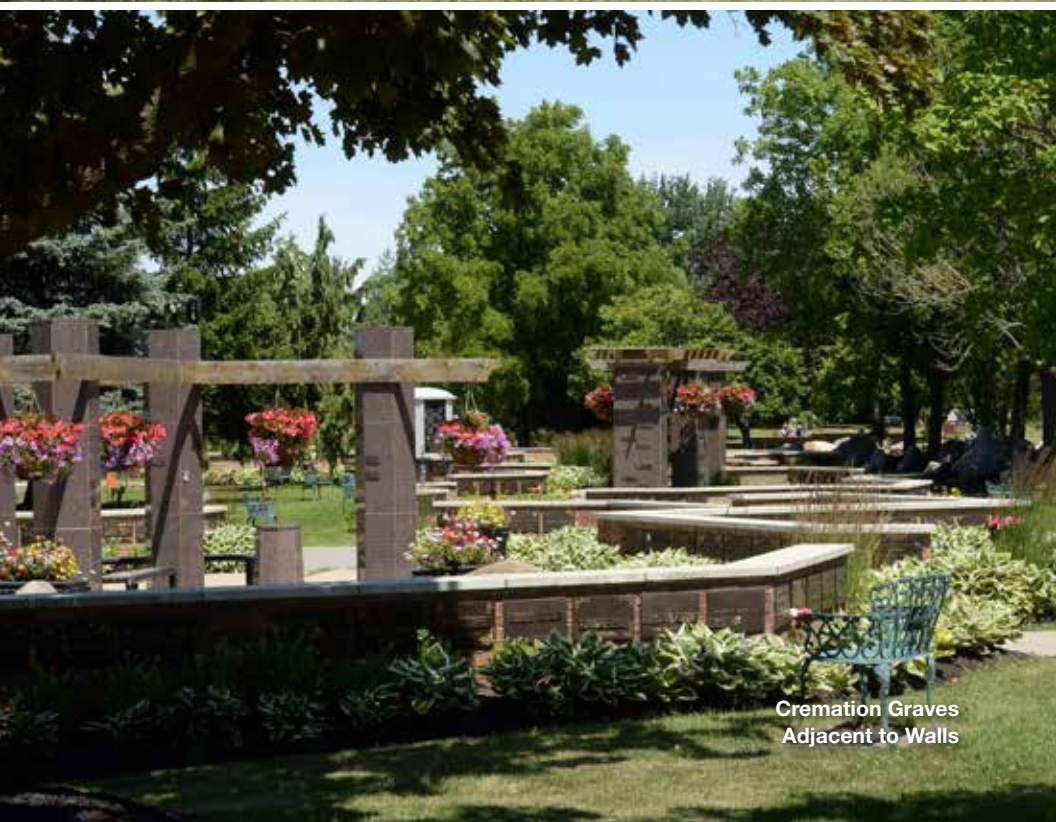

Cremation Graves  
Adjacent to Walls

# THORNTON CEMETERY

Thornton Cemetery has been serving the city of Oshawa, the town of Whitby and neighbouring communities since 1984. The natural park-like setting at Thornton offers a peaceful final resting place, adorned with large flowerbeds, and a tranquil pond.

## Scenic Surroundings

The open green space at Thornton Cemetery creates a pastoral atmosphere that works in harmony with the surrounding environment. The site's ongoing development is dedicated to preserving the natural character and beauty of the landscape for years to come.

## Unique Architecture

The architecture and building materials of the cemetery's office, chapel, mausoleum, funeral centre and cremation centre reflect the rural and religious buildings of Oshawa's history. The warm red brick of the buildings, for example, is found in many of the farm homes of the surrounding countryside, and the main space for memorial services features stained-glass works of art.

## Your Options

Thornton Cemetery includes a wide selection of burial arrangements. For those choosing cremation, cremated remains may be buried in a cremation grave or placed in a niche. Options include wood or glass-fronted niches in our indoor chapel columbaria, as well as an assortment of outdoor columbaria with granite-fronted niches. Thornton also has cremation graves adjacent to walls upon which a bronze marker can be placed, and another granite columbarium with overhead trellises, where colourful flower baskets hang in the summer. If desired, cremated remains can also be scattered in the cremation ossuary.

The veterans' section at Thornton, dedicated to Canadian and Allied veterans and their spouses, is distinguished by a memorial in the form of a beautiful polished granite pyramid set atop a base of rough-hewn granite.



Funeral Centre  
Main Lobby



Funeral Centre  
Lobby and Reception

### *Funeral Centre*

Our newest funeral centre brings the possibility of visitation, funeral, cremation, interment or memorial service and reception together in one stunning building. The chateaux-style centre's timeless design provides an abundance of natural light, a gathering hall which can accommodate intimate to large gatherings and versatile rooms which can be configured or expanded to serve as visitation, service and reception areas. The efficient layout of the facility at Thornton allows families the ability to seamlessly move from funeral service to cremation without leaving the building.

### *Cremation Centre*

Thornton Cremation Centre features a beautiful on-site chapel with stained-glass windows by Canadian artist Mimi Gellman. After a major renovation in 2017, the cremation centre is now outfitted with the most technologically advanced cremation equipment, complete with an abatement system that is virtually emission-free, and a beautifully designed witnessing room, all allowing the convenience of both holding a service and having the cremation take place in the same building.



# TORONTO NECROPOLIS CEMETERY

Characterized by breathtaking natural vistas and distinctive architecture, the Toronto Necropolis Cemetery is one of the city's oldest and most historic cemeteries, providing service since 1850.

## A Historic Site

The Necropolis is the final resting place of many prominent individuals, including Toronto's first mayor, William Lyon Mackenzie, journalist George Brown, John Ross Robertson, founder of the Toronto Telegram newspaper, and former NDP leader Jack Layton. Also buried here are Anderson Ruffin Abbot, the first Canadian-born black surgeon, and world champion oarsman Ned Hanlan. Notable is the monument to honour Samuel Lount and Peter Matthews, hanged in 1838 for their roles in the Mackenzie Rebellion.

## Art and Architecture

The recently restored porte-cochère entrance and chapel are some of Toronto's finest examples of High Victorian Gothic architecture. Beautiful stained-glass windows grace the interior of the chapel, making it a popular choice for services. Our cremation scattering area features a wonderful sculpture by Canadian artist Juliet Jancso. The work depicts a family of three and represents the Depression-era Cabbagetown community. "Onward," a sculpture in polished black granite by Canadian artist Kosso Eloul, forms a central feature for cremation graves in another special area of the cemetery.

## Your Options

For those interested in ground burial, there is still limited space available at the Necropolis. Please check with our office for availability. If cremation is your preference, there are cremation lot areas as well as the marble-fronted niches in our chapel columbarium. Cremated remains can also be scattered in our memorial scattering area, located in the perennial flowerbed and rose garden.





Chapel and Porte-Cochère



Scattering Memorials



BORN  
MAY 14, 1932

BORN  
MAY 23, 1934

Garden of Remembrance

# YORK CEMETERY

Home to the historic Michael Shepard House and an innovative funeral centre, York Cemetery has been providing a unique atmosphere and caring service to North York and its neighbouring communities since 1948.

## Atmosphere and Architecture

Large flowerbeds, blooming tulips, and beautiful pieces of art colour York Cemetery's grounds, while the Michael Shepard House reflects the site's history. The two-storey brick house was built in the early 1850s and is an example of a Georgian-style rural dwelling. The house, where a portion of the cemetery office is located, has been designated by the Toronto Historical Board as having architectural and historical significance.

## Your Options

York offers a wide selection of ground burial alternatives, including single graves with flat markers and lots with upright monuments, and lots for multiple graves. There is also a special veterans' section dedicated to Canadian and Allied veterans and their spouses. The spacious Garden of Remembrance, created for those who choose cremation, offers a peaceful outdoor resting place featuring cremation lots and columbarium niches surrounded by tranquil winding streams and granite memorial boulders. We are also proud to welcome you to Canada's first solar and geothermal powered columbaria, created with both exterior granite niches and interior glass-fronted niches.

Part of what makes York so special is the development of specific areas to meet the needs of the diverse cultures of the surrounding communities. The knowledgeable professionals at York speak a variety of languages and have a wide range of experience serving families from various backgrounds.



Solar and Geothermal  
Columbarium

### *Solar and Geothermal Powered Columbarium*

Opened in 2011, we are pleased to feature Canada's first solar and geothermal powered niche columbarium in the Garden of Remembrance. The building leverages underground temperatures that remain constant year-round with the use of a buried "earth loop."

- Throughout the winter, fluid circulating through the loop absorbs stored heat and carries it indoors, where an indoor heat pump compresses it to a higher temperature and distributes it throughout the building. The process is reversed in the summer. The columbarium also uses solar energy, gathered by roof-mounted solar panels, to generate electric power to operate the heat pump unit's fan, compressor and pump, as well as the building's lighting and other electrical features. The columbarium features granite-fronted niches on the outside of the building, and glass-fronted ones indoors.



**Funeral Centre  
Gathering Hall**

### *Funeral Centre*

The funeral centre at York Cemetery allows you to hold a visitation, funeral, cremation, interment or memorial service, and reception all in one beautiful location. This facility boasts spacious visitation and reception rooms that open onto a balcony patio. The magnificent gathering hall has a vaulted ceiling that lets in abundant natural light, contributing to the facility's bright and open atmosphere.

# MAP OF LOCATIONS

Including other establishments managed by Mount Pleasant Group (MPG)

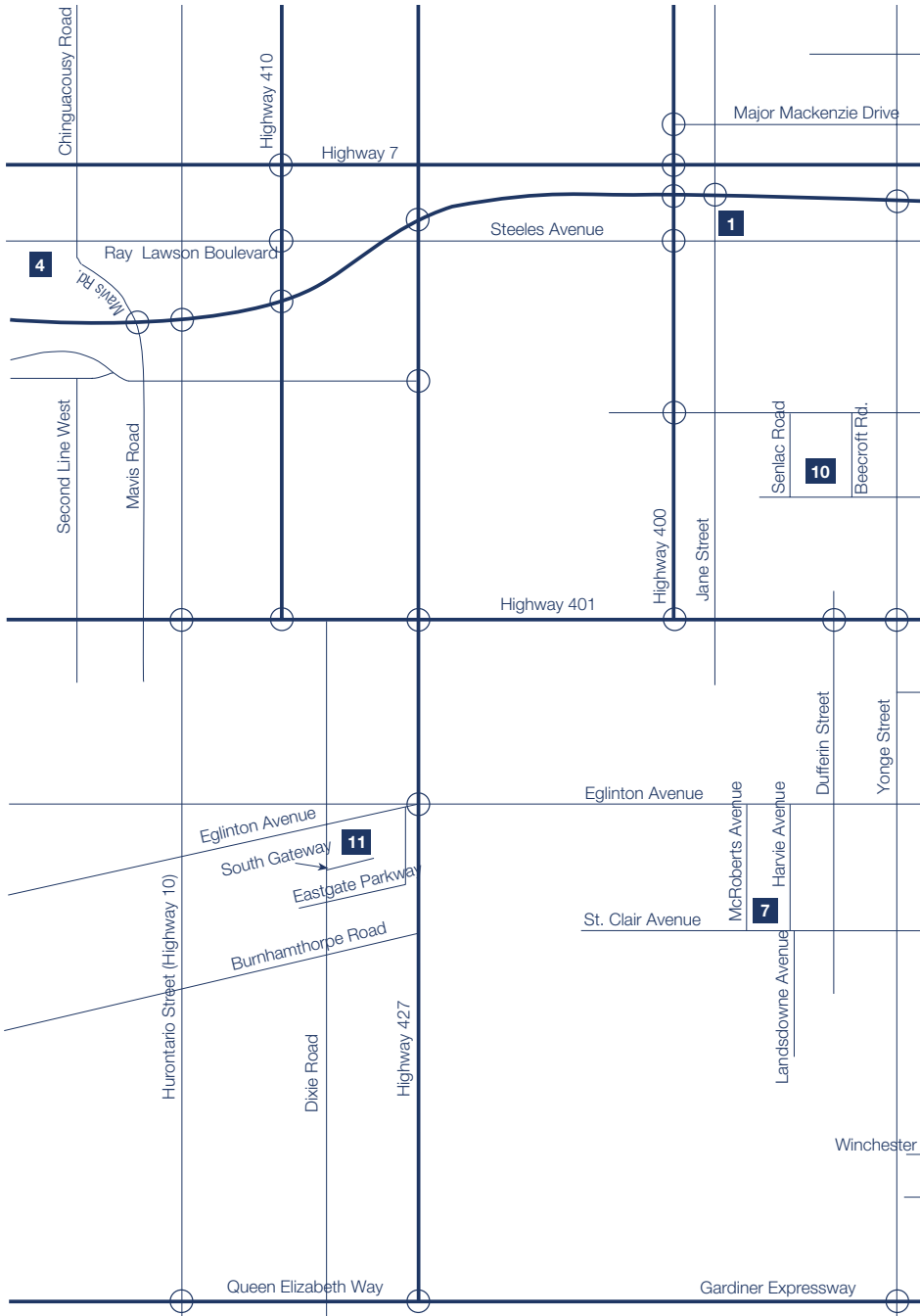



**LEGEND**

- 1** Beechwood Cemetery
- 2** Duffin Meadows Cemetery
- 3** Elgin Mills Cemetery, Cremation and Funeral Centres
- 4** Meadowvale Cemetery, Cremation and Funeral Centres
- 5** Mount Pleasant Cemetery, Cremation and Funeral Centres
- 6** Pine Hills Cemetery and Funeral Centre
- 7** Prospect Cemetery
- 8** Thornton Cemetery, Cremation and Funeral Centres
- 9** Toronto Necropolis Cemetery
- 10** York Cemetery and Funeral Centre
- 11** The Simple Alternative – Mississauga
- 12** The Simple Alternative – Pickering
- 13** The Simple Alternative – Toronto



Map not drawn to scale.

# NOTES

---

---

---

---

---

---

---

---

---

---

---

---

---

---

---

---

---

---

---

---

---

---

---

---

---

---

---

---

---

---





## Establishments Managed by MPG

### **Beechwood Cemetery**

7241 Jane Street  
Vaughan ON L4K 1A7  
905 669 1827

### **Duffin Meadows Cemetery**

2505 Brock Road North  
Pickering ON L1X 0K3  
905 427 3385

### **Elgin Mills Cemetery, Cremation and Funeral Centres**

1591 Elgin Mills Road East  
Richmond Hill ON L4S 1M9  
905 737 1720

### **Meadowvale Cemetery, Cremation and Funeral Centres**

7732 Mavis Road  
Brampton ON L6Y 5L5  
905 451 3716

### **Mount Pleasant Cemetery, Cremation and Funeral Centres**

375 Mount Pleasant Road  
Toronto ON M4T 2V8  
416 485 9129

### **Pine Hills Cemetery and Funeral Centre**

625 Birchmount Road  
Scarborough ON M1K 1R1  
416 267 8229

### **Prospect Cemetery**

1450 St. Clair Avenue West  
Toronto ON M6E 1C6  
416 651 4040

### **Thornton Cemetery, Cremation and Funeral Centres**

1200 Thornton Road North  
Oshawa ON L1J 0C9  
905 579 6787

### **Toronto Necropolis Cemetery**

200 Winchester Street  
Toronto ON M4X 1B7  
416 923 7911

### **York Cemetery and Funeral Centre**

160 Beecroft Road  
North York ON M2N 5Z5  
416 221 3404

### **The Simple Alternative Funeral Centre – Mississauga**

1535 South Gateway Road  
Mississauga ON L4W 5J1  
905 602 1580

### **The Simple Alternative Funeral Centre – Pickering**

1057 Brock Road  
Pickering ON L1W 3T7  
905 686 5589

### **The Simple Alternative Funeral Centre – Toronto**

275 Lesmill Road  
Toronto ON M3B 2V1  
416 441 1580

---

## Did a death just occur?

Call us for immediate assistance: **1-800-408-6033**

**[www.mountpleasantgroup.com](http://www.mountpleasantgroup.com)**

Cemetery and cremation services are provided by Mount Pleasant Group of Cemeteries. Funeral services are provided by Canadian Memorial Services which is affiliated with Mount Pleasant Group of Cemeteries.